



JW MARRIOTT
SINGAPORE SOUTH BEACH

INSPIRED EVENTS.
THOUGHTFULLY CRAFTED.



EVENTS by JW



JW MARRIOTT SINGAPORE SOUTH BEACH



DELUXE ROOM



FLOW18



GRAND BALLROOM

JW Marriott Singapore South Beach

A design-led landmark in Singapore's art and culture district, JW Marriott Singapore South Beach fuses contemporary architecture with restored heritage in a brilliant show of form and function. The luxury hotel features 634 guest rooms including 47 suites, two sky gardens and swimming pools with panoramic views of the Singapore cityscape, the signature Spa by JW, award-winning restaurants and bars, as well as an entertainment-lifestyle destination – The NCO Club.

The hotel houses over 17,000 square feet of event space highlighted by the iconic Grand Ballroom, 15 meeting rooms located in The Assembly – a standalone heritage building with dedicated drop-off as well as Britannia Room located at The NCO Club.

JW Marriott Singapore South Beach is strategically located in close proximity to the Central Business District (CBD), Suntec Singapore Convention & Exhibition Centre and Singapore Sports Hub, leading tourist attractions as well as Esplanade MRT Station and City Hall MRT Interchange.

Accommodation

ROOM CATEGORY	NO. OF ROOMS	SQUARE METRES
Studio Room	51	30
Deluxe Room	271	35
Premier Room	56	40
Premier Marina Bay View Room	48	40
Premier Family Room	36	45
Club Deluxe Room	104	35
Club Premier Room	21	40
Deluxe Suite	24	74
Premier Suite	11	100
Premier Marina Bay View Suite	10	100
Chairman Suite	1	219
Presidential Suite	1	248

Grand Ballroom

Featuring stately Art Deco interiors and an 11,520-light Forest of Lights installation, the Grand Ballroom will create the perfect setting for memorable events and celebrations. The Grand Ballroom's iconic 10m by 15m LED Wall provides an awe-inspiring backdrop to your occasion, complemented by state-of-the-art audiovisual facilities and high-speed wireless internet access.

A heritage building dating back to the 1930s, the beautifully restored Grand Ballroom is located in an exclusive, standalone building and features two outdoor courtyards as well as three levels including a pre-function foyer, the main ballroom with 10m high ceilings, as well as a mezzanine floor that overlooks the main ballroom, perfect for dynamic events for up to 100 guests.

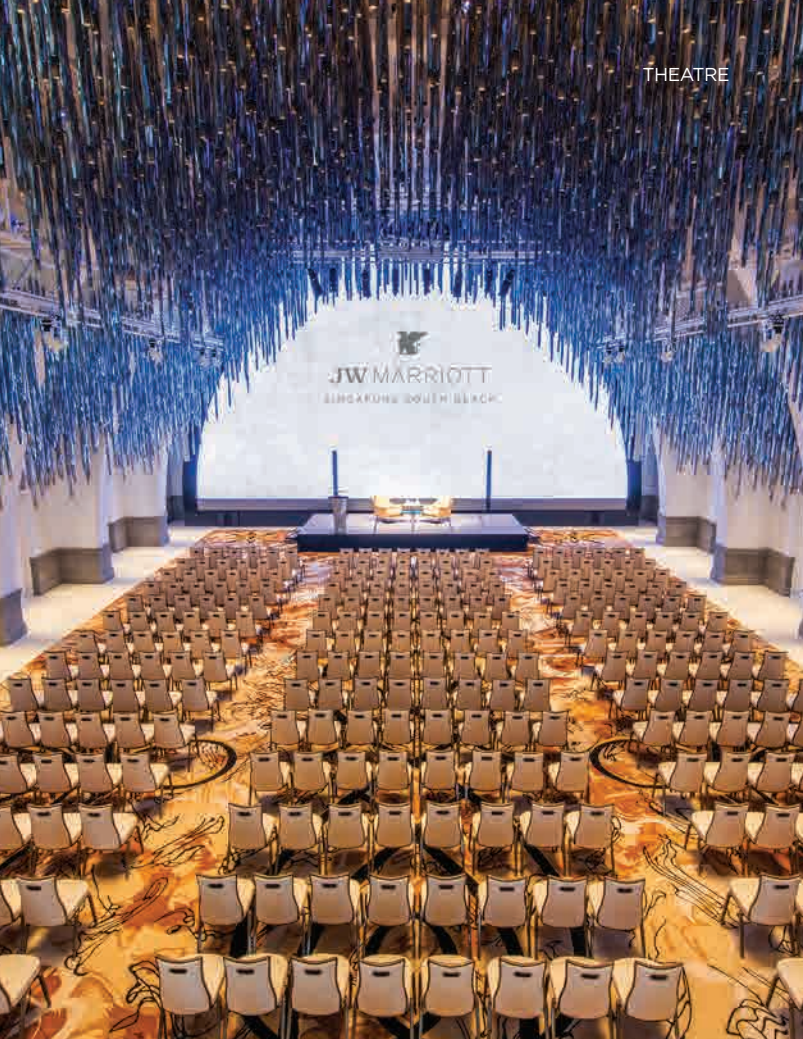

THEATRE



PRE-FUNCTION FOYER



COURTYARD



FLOW18 - SKY TERRACE

Grand Ballroom - Level 1

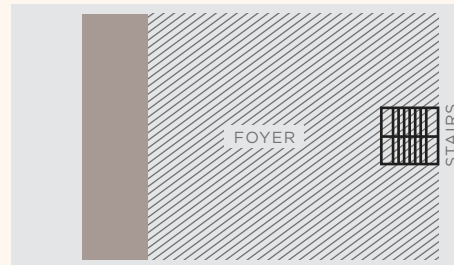

Grand Ballroom - Level 2

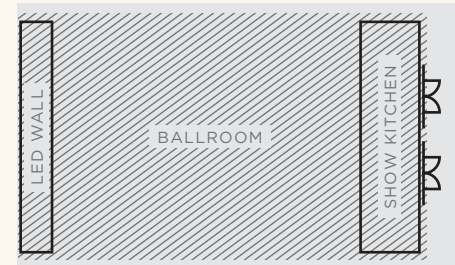

Grand Ballroom - Level 2M



SPACE	DIMENSIONS (L X W X H)	SQUARE METRES	SQUARE FEET	THEATRE	CLASSROOM	CONFERENCE	U-SHAPE	BANQUET
Foyer	17.6 x 17.4 x 3.0	306	3,294	80	30	30	24	60
Ballroom	27.7 x 16.0 x 10.0	443	4,768	420	252	90	75	280
Mezzanine	12.9 x 6.4 x 2.6	82	886	40	36	30	27	50

Flow18

An exclusive venue located on the 18th floor of the South Tower, the Flow18 Sky Garden features panoramic 360-degree views of the surrounding art & culture district as well as being highly flexible to accommodate the event's requirements.

The outdoor venue is perfect for memorable events to socialize and network from product launches to cocktail receptions with an exceptional view.

SPACE	DIMENSIONS (L X W X H)	SQUARE METRES	SQUARE FEET	THEATRE	CLASSROOM	CONFERENCE	U-SHAPE	RECEPTION	BANQUET
Flow18 Event Area	24.0 x 6.0 x 8.0	144	1,550	-	-	-	-	50	40

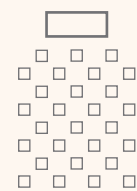

Theater

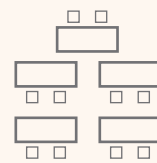

Classroom

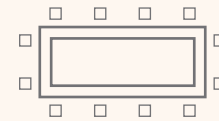

Conference

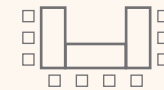

U-shape

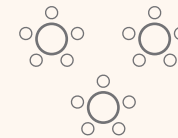

Banquet

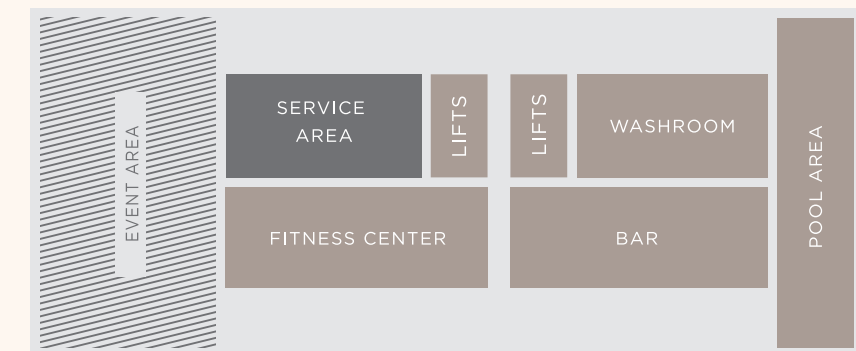



COFFEE BREAK AREA



U-SHAPE



LOUNGE

The Assembly

The hotel's meeting rooms are housed in The Assembly – a conserved heritage building featuring a dedicated drop-off point. Located across two levels, each space can be customisable in a variety of set-ups to suit varied meeting and event needs for group sizes from three to 25.

The 15 meeting rooms are named according to the NATO phonetic alphabet from Alpha to Oscar in homage to The Assembly's military history. The Assembly also features three coffee break areas, as well as Court Martial Bar – open for private events.

The Assembly - Level 1

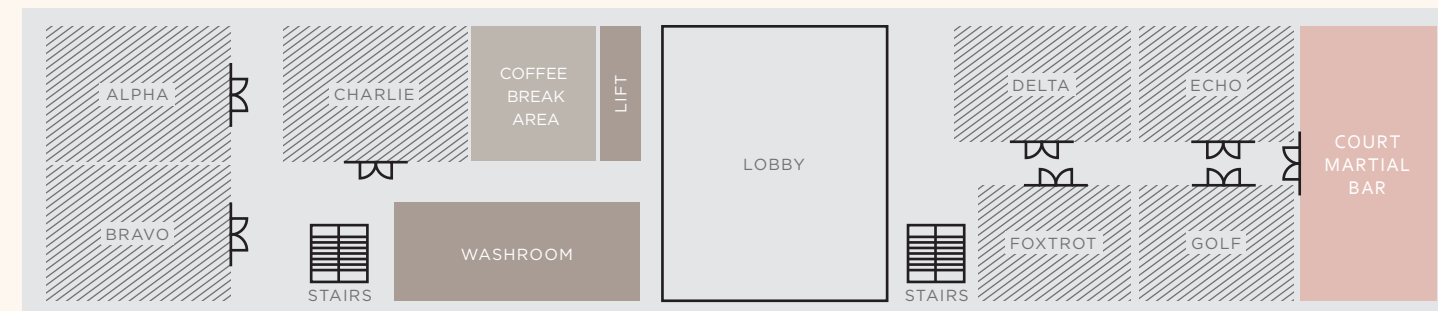

SPACE	DIMENSIONS (L X W X H)	SQUARE METRES	SQUARE FEET	THEATRE	CLASSROOM	CONFERENCE	U-SHAPE	BANQUET
Alpha	8.0 x 5.8 x 3.4	46	498	40	12	12	14	10
Bravo	8.0 x 5.5 x 3.4	44	474	40	12	16	14	10
Alpha / Bravo	8.0 x 11.3 x 3.4	90	968	80	24	20	20	40
Charlie	8.0 x 5.0 x 3.4	40	434	30	16	12	12	10
Delta	8.4 x 4.5 x 3.4	38	406	27	12	12	12	10
Echo	6.1 x 4.5 x 3.4	27	295	30	8	8	8	10
Delta / Echo	14.4 x 4.5 x 3.4	65	698	60	20	28	16	30
Foxtrot	6.8 x 4.6 x 3.4	31	335	27	12	12	12	10
Golf	6.1 x 4.6 x 3.4	28	299	30	8	8	8	10
Foxtrot / Golf	12.9 x 4.6 x 3.4	59	633	60	20	24	16	30

The Assembly - Level 2

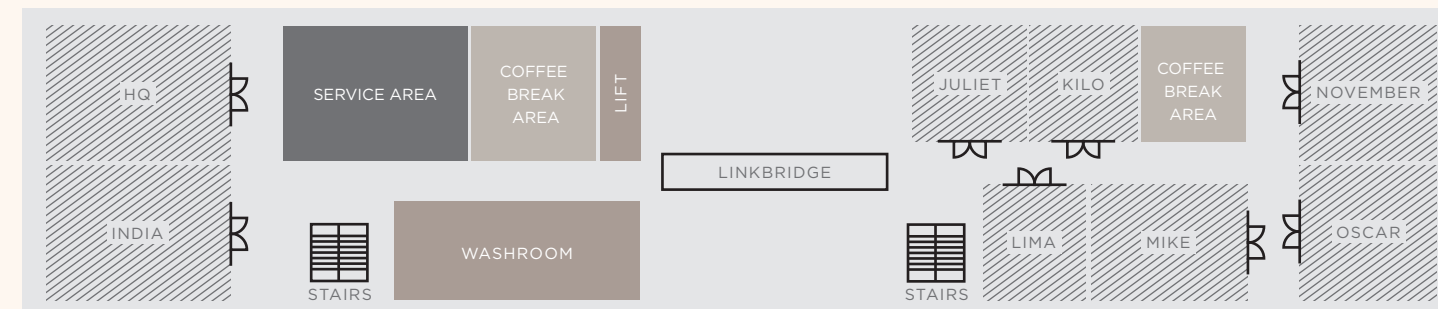

SPACE	DIMENSIONS (L X W X H)	SQUARE METRES	SQUARE FEET	THEATRE	CLASSROOM	CONFERENCE	U-SHAPE	BANQUET
HQ	8.1 x 5.8 x 3.4	47	509	33	12	8	12	20
India	8.1 x 5.7 x 3.4	46	495	33	12	8	12	20
HQ / India	8.1 x 11.7 x 3.4	95	1,019	72	30	20	24	50
Juliet	4.9 x 5.8 x 3.4	28	301	18	8	4	6	10
Kilo	4.9 x 5.8 x 3.4	28	303	18	8	4	6	10
Juliet / Kilo	9.8 x 5.8 x 3.4	56	603	36	16	12	14	20
Lima	4.0 x 4.3 x 3.4	17	182	20	4	6	0	8
Mike	6.6 x 4.3 x 3.4	28	303	20	10	8	8	10
Lima / Mike	10.6 x 4.3 x 3.4	45	486	40	14	16	14	20
November	7.4 x 5.7 x 3.4	43	460	33	12	8	12	20
Oscar	7.4 x 5.4 x 3.4	40	431	33	12	8	12	20
November / Oscar	7.4 x 11.1 x 3.4	83	889	72	30	32	24	50



Britannia Room

Located at the entertainment-lifestyle destination The NCO Club, Britannia Room is a private event venue perfect for inspiring events from exclusive dinners to breakout meetings or product launches.

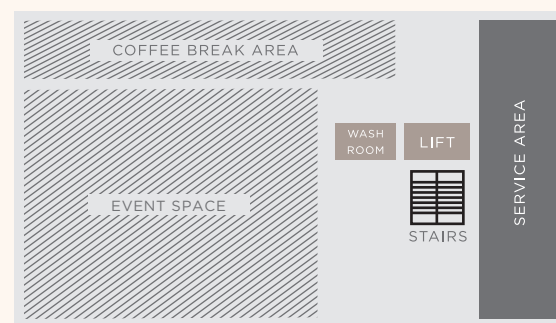

SPACE	DIMENSIONS (L X W X H)	SQUARE METRES	SQUARE FEET	THEATRE	CLASSROOM	CONFERENCE	U-SHAPE	RECEPTION	BANQUET
Britannia Room	11.3 x 6.4 x 3.4	72	778	70	30	20	24	70	60

Court Martial Bar

Located in a conserved heritage building, Court Martial Bar is one of downtown Singapore's most eclectic venues for private events.

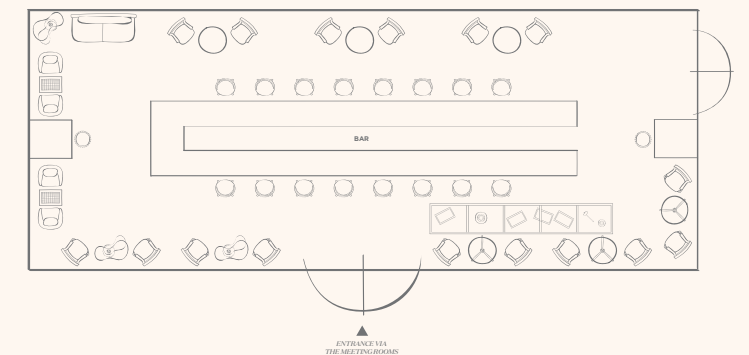

SPACE	SEATED	COCKTAIL
Court Martial Bar	30	50



AKIRA BACK



BEACH ROAD KITCHEN



MADAME FAN



FISH POOL

RESTAURANTS & BARS

Providing culinary experiences that cater to a myriad of tastes.



Akira Back
Level B1M, South Tower

Featuring signature modern Japanese cuisine, the award-winning Akira Back showcases innovative dishes centered around Chef Akira Back's Korean heritage and American roots.

Lunch
12.00 pm to 2.30 pm (Monday to Sunday)

Dinner
6.00 pm to 10.30 pm (Monday to Sunday)

Capacity
Seated: 98 persons



Tonic
Lobby, South Tower

A specialty gin bar, Tonic boasts a handpicked selection of over 100 gins from around the world for perfect gin and tonic pairings.

8.00 am to 12.00 mn (Monday to Sunday)

Capacity
Seated: 32 persons



Beach Road Kitchen
Level 1, South Beach Avenue

Situated in the heart of South Beach, Beach Road Kitchen celebrates seafood with chefs on show.

Breakfast
6.30 am to 10.30 am (Monday to Sunday)

A La Carte
12.00 pm to 10.00 pm (Monday to Sunday)

Chefs-On-Show Buffets
Lunch
12.00 pm to 2.30 pm (Monday to Saturday)

Brunch
12.00 pm to 3.00 pm (Sunday)

Dinner
6.00 pm to 10.00 pm (Monday to Sunday)

Capacity
Seated: 204 persons



Madame Fan
Level 2, The NCO Club

Experience a lifestyle-dining concept showcasing modern Cantonese cuisine with East meet West cocktails.

Lunch
12.00 pm to 2.30 pm (Monday to Friday)

Brunch
11.00 am to 3.30 pm (Saturday, Sunday and Public Holidays)

Dinner
6.00 pm to 10.00 pm (Monday to Sunday)

Madame Fan Bar
Open during Lunch, Brunch & Dinner

Capacity
Seated: 195 persons



Cool Cats
Level 1, The NCO Club

Spearheading Singapore's cocktail scene, Cool Cats features craft cocktails inspired by jazz music history and live performances by international artists.

7.00 pm to 12.00 am (Tuesday to Saturday)

Capacity
Seated: 100 persons



Fish Pool
Level 1, The NCO Club

Fish Pool is a raw bar showcasing seafood three ways - sashimi, crudo and ceviche, complemented by mermaid performances.

6.00 pm to 10.00 pm (Friday & Saturday)



Stags' Room
Level 1, The NCO Club

Stags' Room is an intimate and lush wine lounge featuring a private reserve on wines from France, Italy and more by coravin.

5.00 pm to 11.00 pm (Tuesday to Saturday)

Capacity:
Seated 25 persons

Hotel Map

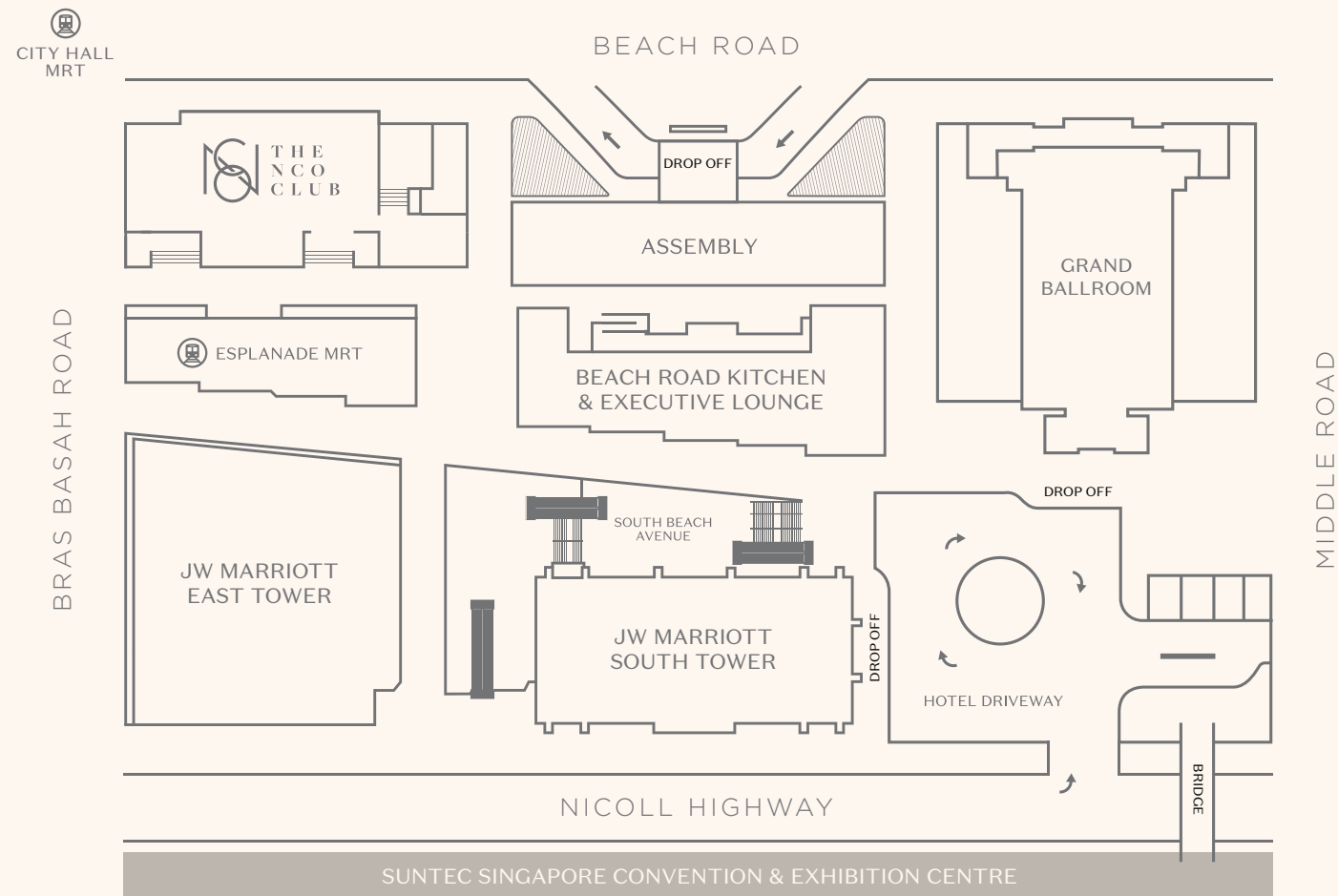

JW Marriott South Tower

- Lobby & Reception
- Akira Back (B1M)
- Tonic (L1)
- Flow18 Swimming Pool & Sky Garden (L18)
- Fitness Centre (L18)

Assembly

- Court Martial Bar (L1)
- Meeting Rooms (L1 & 2)

JW Marriott East Tower

- Spa by JW (L2)
- Ebb6 Swimming Pool & Sky Garden (L6)

Beach Road Kitchen & Executive Lounge

- Beach Road Kitchen (L1)
- Executive Lounge (L2)

The NCO Club

- Cool Cats (L1)
- Fish Pool (L1)
- Stags' Room (L1)
- Madame Fan (L2)
- Britannia Room (L3)

Directions

- Direct access to Esplanade MRT Station
- Connected to Suntec Singapore Convention & Exhibition Centre via linkbridge
- 5-min walk to City Hall MRT Interchange (0.6km)
- 22-min drive to Changi International Airport (18.0km)

EVENTS BY JW

Through memorable culinary experiences, JW sets the stage for exceptional events. The planning begins with a menu thoughtfully crafted to delight the palate with fresh, authentic cuisine that celebrates local tastes and overall well-being. To add some flavor to your meeting, our 'Chefs on Show' showcases top culinary talent bringing the art of food to life through demonstrations and storytelling. Let our expert planners create an experience that each and every one of your guests will savor throughout the event and beyond.

ACCOMMODATION

634 guest rooms and suites
Executive lounge
Direct access to Esplanade MRT Station
5-minutes to City Hall MRT Interchange
20-minutes from Changi International Airport

GUEST SERVICES

24-hour in-room dining
24-hour security
Airport limousine service
Express check-in and check-out
Currency exchange
Housekeeping and turndown service
Laundry and dry-cleaning
Safe deposit box
Parking
Wireless internet access

RESTAURANTS & LOUNGES

Akira Back | Modern Japanese celebrity restaurant
Beach Road Kitchen | Award-winning international buffet
Tonic | Lobby lounge and gin bar
Madame Fan | Lifestyle-dining Cantonese restaurant
Cool Cats | Live jazz and cocktail bar
Fish Pool | Raw bar with mermaid show
Stags' Room | Private wine reserve

RECREATION & LEISURE

Flow18 | Sky garden and swimming pool
Ebb6 | Sky garden and outdoor swimming pool
24-hour fitness centre
The signature Spa by JW

MEETING FACILITIES

Over 17,000 square feet of meetings and events spaces including:
The Grand Ballroom
15 meeting rooms
2 outdoor event venues
Britannia Room located at The NCO Club

ATTRACTIONS

Located in Singapore's art and culture district. In close proximity to leading attractions including:
The Merlion
National Gallery Singapore
The Esplanade
Gardens by the Bay

JW MARRIOTT SINGAPORE SOUTH BEACH

30 Beach Road, Singapore 189763
(Access via Nicoll Highway)
Tel +65 6818 1888
Email jw.sinjw.sales@marriott.com
jwmarriottsingapore.com